



---

# RAUVITHERM AND RAUTHERMEX

## Parts List

---

# CONTENTS

<b>1</b>	<b>RAUTHERMEX</b>	<b>3</b>
1.1	RAUTHERMEX pipe	3
1.2	RAUTHERMEX Shrouds	4
1.3	RAUTHERMEX House Entries	7
<b>2</b>	<b>RAUVITHERM</b>	<b>12</b>
2.1	RAUVITHERM pipe	12
2.2	RAUVITHERM Shroud Kits	13
2.3	RAUVITHERM House Entries	15
<b>3</b>	<b>Special Accessories</b>	<b>19</b>
<b>4</b>	<b>REHAU EVERLOC™ Jointing Technology</b>	<b>20</b>
<b>5</b>	<b>Installation Aids</b>	<b>31</b>

# 1 RAUTHERMEX SDR 11

## 1.1 RAUTHERMEX SDR 11

- Properties: - Suitable up to max . 95 °C (short bursts) and 6 bar  
 - Delivery: in coils
- Comprising: - Carrier pipes: cross-linked polyethylene (PE-Xa) according to DIN 16892/93 and DIN EN 15632 with orange oxygen diffusion barrier (EVOH) in accordance with DIN 4726  
 - Continuously foamed CFC-free insulation (except for 160mm straight lengths)  
 - Outer jacket: grey, corrugated, seamlessly extruded polyethylene (PE-LLD)
- Colour: Light grey

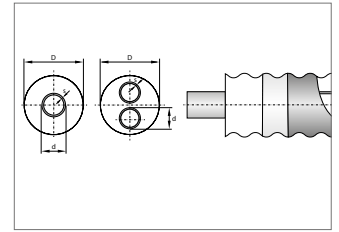

Article No.	Description	d	s	D	U-value	Volume	2.8 m x 0.8 m	2.8 m x 1.2 m	Weight	Pack Qty
		mm	mm	mm	W/m <sup>2</sup> K	l/m	m	m	kg/m	m
<b>UNO</b>										
352161-001	25/91	25	2.3	93	0.099	0.327	370	570	1.28	570
352171-001	32/91	32	2.9	93	0.121	0.539	370	570	1.38	570
352885-001	32/111	plus	32	2.9	113	0.103	0.539	275	400	1.69
352181-001	40/91	40	3.7	93	0.151	0.835	370	570	1.48	570
352895-001	40/126	plus	40	3.7	128	0.111	0.835	195	305	2.18
352191-001	50/111	50	4.6	113	0.155	1.307	275	400	2.11	400
352905-001	50/126	plus	50	4.6	128	0.136	1.307	195	305	2.64
352201-001	63/126	63	5.8	128	0.177	2.075	195	305	2.86	305
352915-001	63/142	plus	63	5.8	144	0.154	2.075	140	225	3.49
352211-001	75/162	plus	75	6.8	164	0.162	2.961	95	150	4.37
352221-001	90/162	90	8.2	164	0.206	4.254	95	150	5.02	150
352925-001	90/182	plus	90	8.2	185	0.175	4.254	52	86	5.61
352231-001	110/162	110	10	164	0.296	6.362	95	150	5.78	150
352935-001	110/182	plus	110	10	185	0.236	6.362	52	86	6.64
356665-001	110/202	plusplus	110	10	202	0.2	6.362	46	75	7.29
352241-002	125/182	125	11.4	185	0.303	8.203	52	86	7.2	86
356637-001	125/202	plus	125	11.4	206	0.277	8.203	46	75	7.85
303867-001	140/202	140	12.7	206	0.308	10.315	46	75	8.38	75
352251-001	160/250	160	14.6	207	0.303	13.437	12*	-	14.17	12
<b>DUO</b>										
356642-001	20 + 20/111	20	1.9	113	0.116	0.206	275	400	1.65	400
352261-001	25 + 25/111	25	2.3	113	0.139	0.327	275	400	1.85	400
352271-001	32 + 32/111	32	2.9	113	0.183	0.539	275	400	2.11	400
352945-001	32 + 32/126	plus	32	2.9	128	0.157	0.539	195	305	2.5
352281-001	40 + 40/126	40	3.7	128	0.211	0.835	195	305	2.75	305
352955-001	40 + 40/142	plus	40	3.7	144	0.174	0.835	140	225	3.32
352291-001	50 + 50/162	50	4.6	164	0.195	1.307	95	150	4.25	150
352965-001	50 + 50/182	plus	50	4.6	185	0.166	1.307	52	86	4.9
352301-001	63 + 63/182	63	5.8	185	0.238	2.075	52	86	5.45	86
356612-001	63 + 63/202	plus	63	5.8	206	0.208	2.075	46	75	5.9
356671-001	75 + 75/202	75	6.8	206	0.28	2.961	46	75	6.7	75

\*12 m straight lengths

## 1.2 RAUTHERMEX Shroud Kits

### RAUTHERMEX T-shroud for Branches

- Properties:
- To adapt the T-shroud to different RAUTHERMEX outer jacket diameters, 3 sealing rings of the corresponding size must be used.
  - The REHAU shroud foam to be used for insulation
- Comprising:
- Shroud set made from ABS (76 - 126 or 76 - 182)
  - Clips made from POM (16 or 27)
  - Shroud plugs made from POM including valve, sealing ring and plug (3)
  - Shroud glue (1)
  - Assembly instructions

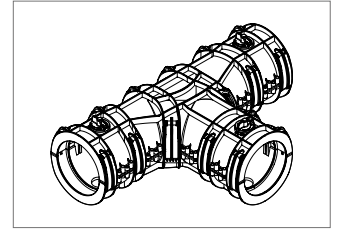

Article No.	Description	Outer Jacket	Outer Jacket	L	H	Weight	Pack Qty
		$d_{min}$ mm	$d_{max}$ mm				
330055-001	<b>NEW</b> T - shroud small Generation III	91	126	643	415	2.817	1
351054-001	T - shroud large	91	182	740	500	8	1

### RAUTHERMEX I-shroud for Straight Connections

- Properties:
- To adapt the I-shroud to different RAUTHERMEX outer jacket diameters. 2 sealing rings of the corresponding size must be used
  - The REHAU shroud foam to be used for insulation
- Comprising:
- Shroud set made from ABS (76 - 126 or 76 - 182)
  - Clips made from POM (12 or 22)
  - Shroud plugs made from POM including valve, sealing ring and plug (2)
  - Shroud glue (1)
  - Assembly instructions

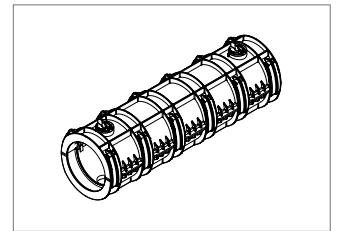

Article No.	Description	Outer Jacket	Outer Jacket	L	Weight	Pack Qty
		$d_{min}$ mm	$d_{max}$ mm			
330056-001	<b>NEW</b> I - shroud small Generation III	91	126	642	2.2	1
352038-001	I - shroud large	91	182	752	4.5	1

## RAUTHERMEX L-shroud for Elbow Connections

- Properties:
- To adapt the L-shroud to different RAUTHERMEX outer jacket diameters, 2 sealing rings of the corresponding size must be used
  - The REHAU shroud foam to be used for insulation
- Comprising:
- Shroud set made from ABS (76 - 126 or 76 - 182)
  - Clips made from POM (14 or 22)
  - Shroud plugs made from POM including valve, sealing ring and plug (2)
  - Shroud glue (1)
  - Assembly instructions

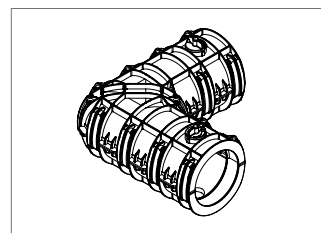

Article No.	Description	Outer Jacket $d_{min}$ mm	Outer Jacket $d_{max}$ mm	L mm	H mm	Weight kg/pc	Pack Qty pc
330057-001	<b>NEW</b> L-shroud small Generation III	91	126	415	415	2.1	1
352039-001	L-shroud large	91	182	508	508	4.4	1

## RAUTHERMEX Sealing Rings - small

- Application: To seal the shroud kit to the RAUTHERMEX pipe
- Properties:
- Every branch of the shroud is to be sealed off with the matching sealing ring
  - Inner diameter of sealing ring = Outer diameter of the pipe
- Material:
- EPDM
  - Stainless steel clamping stramp
  - Hard plastic ring

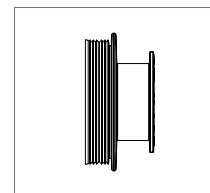
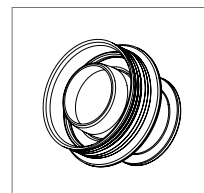

Article No.	Description	$D_i$ mm	Weight kg/pc	Pack Qty pc
330017-001	<b>NEW</b> 91 mm, suitable for Shroud small	91	0.33	1
330018-001	<b>NEW</b> 111 mm, suitable for Shroud small	111	0.21	1
330019-001	<b>NEW</b> 126 mm, suitable for Shroud small	126	0.	1

## RAUTHERMEX Sealing Rings - large

- Application: To adjust the shroud kit to the RAUTHERMEX pipe
- Properties:
- Every branch of the shroud is to be sealed off with the matching sealing ring
  - Inner diameter of sealing ring = Outer diameter of the pipe
- Material: EPDM

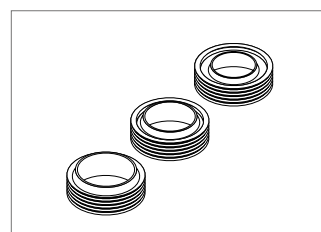

Article No.	Description	$D_i$ mm	Weight kg/pc	Pack Qty pc
351056-001	91 mm, suitable for Shroud large	91	1.04	1
351057-001	111 mm, suitable for Shroud large	111	0.9	1
351058-001	126 mm, suitable for Shroud large	126	0.82	1
351059-001	142 mm, suitable for Shroud large	142	0.88	1
351061-001	162 mm, suitable for Shroud large	162	0.78	1
351062-001	182 mm, suitable for Shroud large	182	0.58	1

## REHAU Shroud Foam

- Application: For the installation of RAUTHERMEX shrouds and REHAU shrink shrouds
- Comprising:
- Foam bottle component A
  - Foam bottle component B
  - Nozzle cap
  - Assembly instructions
- Note: Please observe the assembly instructions and safety instructions and datasheets

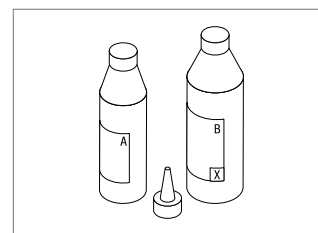

Article No.	Description	Suitable for RAUTHERMEX Shroud	Suitable for Shrink Sleeve	Weight	Pack Qty
				kg/pc	pc
298357-001	Size 5	RTX I- and L-shroud small	Shrink sleeve I small	0.805	1
209596-001	Size 6	RTX T-shroud small	Shrink sleeve L small	0.875	1
352413-001	Size 8	RTX I- and L-shroud large	Shrink sleeve I large	1.712	1
351063-001	Size 9.1	RTX T-shroud large	Shrink sleeve T large	2.212	1

## RAUTHERMEX Coupling Shroud Sets - Special Applications

- Application: For connecting RAUTHERMEX and/or steel pre-insulated pipes
- Comprising:
- PE-moulding
  - Abrasive belt
  - Heat-shrink sleeves/tape
  - Air bleeding valves
  - Polyurethane foam

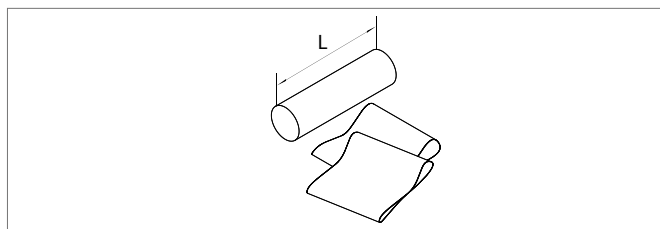

Article No.	Description	Outer Jacket	Outer Jacket	L	Weight	Pack Qty
		$d_{min}$	$d_{max}$		kg/pc	pc
		mm	mm	mm		
201903-001	Special application 182/200 mm	180	200	600		1
215627-001	Special application 182/250 mm	180	250	600	3.8	1
209979-001	Special application 202/225 mm	200	225	600		1
215628-001	Special application 202/250 mm	200	250	600	3.9	1
298822-001	Special application 250/250 mm	250	250	600	4	1

### 1.3 House Entries RAUTHERMEX

#### REHAU Pre-fabricated Pipe Bend

- Properties:
- Suitable up to max. 95 °C (short bursts) and 6 bar
  - Elbow in outer jacket made up of segments butt-welded to create a bend.
  - Pipe bend length: 1100 mm x 1600 mm
  - Leg length at: 160/250, 1500mm x 1500mm
  - Exposed pipe ends: 250 mm
- Comprising:
- Pre-curved carrier pipe made of cross-linked polyethylene (PE-Xa) in accordance to DIN 16892/93. DIN EN 15632 and oxygen diffusion barrier (EVOH) according to DIN 4726
  - Insulation made from CFC-free, pentane driven polyurethane rigid foam
  - Outer jacket pipe: PE-HD black

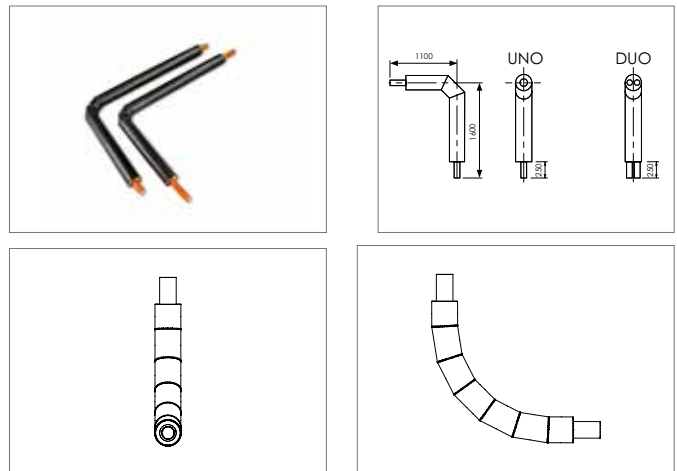

Article No.	Description	d	s	D	Weight	Pack Qty
		mm	mm	mm	kg/pc	pc
<b>UNO</b>						
240004-001	25/91	25	2.3	90	2.85	1
240064-001	32/91	32	2.9	90	3.07	1
240074-001	40/91	40	3.7	110	3.47	1
240084-001	50/111	50	4.6	110	4.92	1
240094-001	63/126	63	5.8	125	6.5	1
240054-001	75/162	75	6.8	160	8.47	1
240114-001	90/162	90	8.2	160	11.4	1
240124-001	110/162	110	10	160	14.23	1
222827-001	125/182	125	11.4	180	16.03	1
222837-001	160/250	160	14.6	250	26.55	1
<b>DUO</b>						
240194-001	25 + 25/111	2x 25	2.3	110	4.71	1
240224-001	32 + 32/111	2x 32	2.9	110	4.67	1
240234-001	40 + 40/126	2x 40	3.7	125	7.42	1
240244-001	50 + 50/162	2x 50	4.6	160	9.9	1
243788-001	63 + 63/182	2x 63	5.8	180	13.2	1
315375-001	75 + 75/202	2x 75	6.8	200	14.6	1

## RAUTHERMEX Pre-fabricated Steel Pipe Bend (Steel)

- Properties: - Suitable up to max. 95 °C (short bursts) and 6 bar  
 - Bend Length: 1100 mm x 1100 mm
- Comprising: - Carrier pipes  
 - Insulation  
 - Outer jacket  
 - Two welded REHAU couplers with dimensions  
 140 x 12.7 mm / 160 x 14.6 mm  
 - Two REHAU compression sleeves
- Material: - Carrier pipes: Steel  
 - Insulation: CFC-free polyurethane rigid foam  
 - Outer jacket: PE-HD black

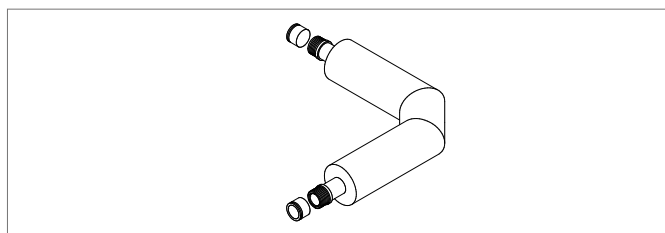

Article No.	Description	Dimension Coupler	Dimension Compression Sleeve	d	Weight	Pack Qty
				mm	kg/pc	pc
209138-001	140/225 mm, steel	140 x 12.7 - 139.7 x 3.6	140 x 12.7	225	70	1
201227-001	160/250 mm, steel	160 x 14.6 - 168.3 x 4.1	160 x 14.6	250	80	1

## Wall Sealing Ring (Dry)

- Application: Suitable as a building inlet through masonry, in conjunction with expansive mortar for non-pressured water. Watertight up to 2m water column
- Material: Profiled natural rubber
- Colour: Black (RAL 9005)

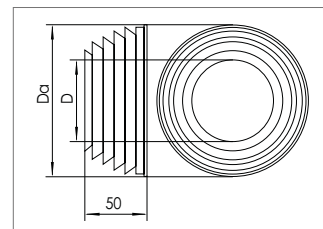

Article No.	Description	D	D <sub>a</sub>	RTX UNO	RTX DUO	RVT UNO	RVT DUO	Weight	Pack Qty
		mm	mm					kg/pc	pc
240363-001	91/133 mm	91	133	25, 32, 40				0.4	1
240373-001	111/153 mm	111	153	32*, 50	25,32	25,32		0.5	1
240383-001	126/168 mm	126	168	40*, 50*, 63	32*, 40	40		0.5	1
240393-001	142/183 mm	142	183	63*	40*	50,63	25,32,40	0.6	1
240403-001	162/203 mm	162	203	75, 90, 110	50	75		0.7	1
239101-001	182/223 mm	182	223	90*, 110*, 125	50*, 63	90, 110	50	0.8	1
353278-001	202/234 mm	202	234	125*, 140, 110**	63*, 75	125	63	0.9	1
219983-001	225/261 mm	225	261	for lead in bend 140/225				1	1
298818-001	250/286 mm	250	286	160				1.1	1

\*plus insulation

\*\*plusplus insulation



### RAUTHERMEX Wall Sealing Ring FA 80

- Application: Suitable as a seal through concrete and in the casing pipe through masonry where water pressure exists (up to 15m water column) in combination with RAUTHERMEX
- Properties: - For secure sealing and adequate stabilisation of the pipe, the wall sealing ring FA80 in a feed through duct is also recommended  
- Width: approx. 90 mm
- Comprising: - Seal rubber EPDM Shore 40° ± 5°  
- Seal plates and screws made of V2A

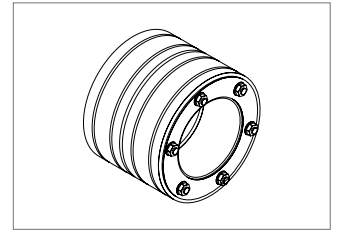

Article No.	Description	D <sub>i</sub>	Torque	SW	Core Holes D <sub>a</sub>	Weight	Pack Qty
		mm	Nm		mm	kg/pc	pc
285431-001	91/150	91*	5	10	150	1.612	1
285441-001	111/200	111*	10	13	200	3.092	1
285451-001	126/200	126*	10	13	200	2.564	1
285461-001	142/200	142*	10	13	200	2.35	1
285471-001	162/250	162*	10	13	250	3.764	1
285481-001	182/250	182*	10	13	250	3.236	1
219376-001	202/300	202*	10	13	300	5.28	1
298812-001	250/350	250**	10	13	350	7.2	1

\*± 2

\*\*± 3

### RAUTHERMEX Wall Sealing Ring FA 40

- Application: Suitable as a seal through concrete and in the casing pipe through masonry where water pressure exists (up to 15m water column) in combination with RAUTHERMEX
- Properties: - For adequate stabilisation of the pipes, two wall sealing flanges FA 40 in a feed-through duct are recommended.  
- Width: approx. 50 mm
- Comprising: - Seal rubber EPDM Shore 40° ± 5°  
- Seal plates and screws made of V2A  
- Seal rubber in accordance with KTW recommendation

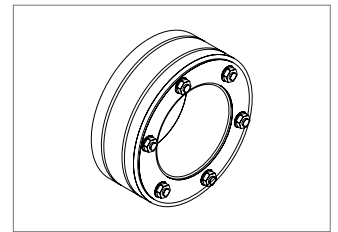

Article No.	Description	D <sub>i</sub>	Torque	SW	Core Holes D <sub>a</sub>	Weight	Pack Qty
		mm	Nm		mm	kg/pc	pc
285501-001	91/150	91	5	10	150	1.072	1
285511-001	111/200	111	10	13	200	2.066	1
285521-001	126/200	126	10	13	200	1.668	1
285531-001	142/200	142	10	13	200	1.47	1
285541-001	162/250	162	10	13	250	2.43	1
285551-001	182/250	182	10	13	250	2.488	1
218311-001	202/300	202	10	13	300	3.472	1
298815-001	250/350	250	10	13	350	5.102	1

## RAUTHERMEX Casing Pipe

Application: Suitable for wall sealing rings FA 40 and FA 80  
 Properties: - Heavily roughened surface for sealing securely against masonry or concrete  
 - Casing pipe can be embedded in concrete together with formwork supports in concrete building structures  
 Material: PVC

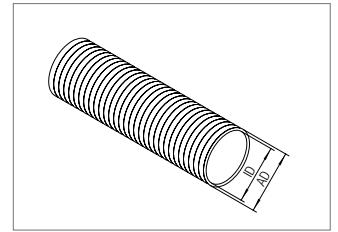

Article No.	Description	ID	AD	L	Weight	Pack Qty
		mm	mm	mm	kg/pc	pc
222774-001	Pipe sleeve 125 (131 x 3.0)	125	131	600	1.19	1
222784-001	Pipe sleeve 150 (160 x 5.0)	150	160	600	1.95	1
222794-001	Pipe sleeve 200 (210 x 5.0)	200	210	600	2.76	1
222804-001	Pipe sleeve 250 (280 x 15)	250	280	600	9.41	1

## Pipe Sleeve Protective Cap

Application: For fixing the casing pipes in concrete wall formwork  
 Material: PE-LD  
 Colour: Yellow

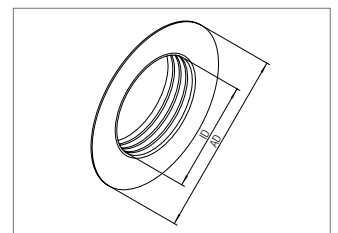

Article No.	Description	ID	AD	L	Weight	Pack Qty
		mm	mm	mm	kg/pc	pc
222814-001	for casing pipe sleeve 125 mm	125	205	20	0.067	1
222824-001	for casing pipe sleeve 150 mm	150	245	20	0.102	1
222834-001	for casing pipe sleeve 200 mm	200	300	18	0.152	1
222844-001	for casing pipe sleeve 250 mm	250	395	18	0.294	1

## Epoxy Resin Kit

Application: For sealing the concrete or masonry  
 Properties: **Note:** Please observe the assembly instructions and safety datasheets  
 Comprising: - Two component epoxy resin  
 - Brush (length: aprox. 40 cm)  
 - 1 pair of latex gloves  
 - Assembly instructions

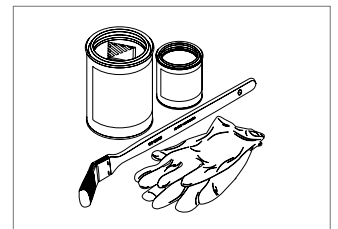

Article No.	Description	Weight	Pack Qty
		kg/pc	pc
222854-001	Coverage for 3.5m <sup>2</sup> area	1.4	1

### RAUTHERMEX Rubber End Cap

Application: Suitable for the protection of foamed pipe ends from moisture

Material: EPDM

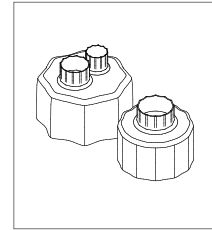
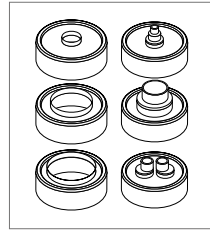

### RAUTHERMEX Heat-shrink End Cap (wet)

Application: Suitable for protecting foamed pipe ends against moisture

Material: Shrinkable PE-X coated with glue

Pipe	Rubber End Cap	Heat-shrink End Cap
<b>UNO</b>		
25/91	216397-001	209961-001
32/91	216397-001	209961-001
32/111	216398-001	209961-001
40/91	216397-001	209961-001
40/126	218179-001	209961-001
50/111	216398-001	209961-001
50/126	218179-001	209962-001
63/126	218179-001	209962-001
63/142	320021-001	209962-001
75/162	218185-001	209963-001
90/162	218185-001	209963-001
90/182	218186-001	209963-001
110/162	218185-001	209963-001
110/182	218186-001	209963-001
110/202	320041-001	209963-001
125/182	218186-001	209963-001
125/202	218187-001	209963-001
140/202	218187-001	209963-001
160/250	218188-001	298821-001
<b>DUO</b>		
20+20/111	216399-001	209964-001
25+25/111	216399-001	209964-001
32+32/111	216399-001	209966-001
32+32/126	218189-001	209966-001
40+40/126	218189-001	209966-001
40+40/142	320007-001	209966-001
50+50/162	218191-001	209967-001
50+50/182	218192-001	209968-001
63+63/182	218192-001	209968-001
63+63/202	320061-001	209968-001
75+75/202	320061-001	209968-001

## 2 RAUVITHERM SDR 11

### 2.1 RAUVITHERM SDR 11

- Properties: - Suitable for up to max. 95 °C (short bursts) and 6 bar  
- Delivery: in coils
- Comprising: - Carrier pipes  
- Insulation  
- Outer jacket
- Material: - Carrier pipes: cross-linked polyethylene (PE-Xa) in accordance with DIN 16892/93 and DIN EN 15632 with orange oxygen diffusion barrier (EVOH) in accordance with DIN 4726  
- Insulation: cross-linked PE foam sheets with DUO pipes and an additional white foam section  
- Outer jacket: Black, corrugated outer jacket made of polyethylene (PE-LLD)
- Colour: Black

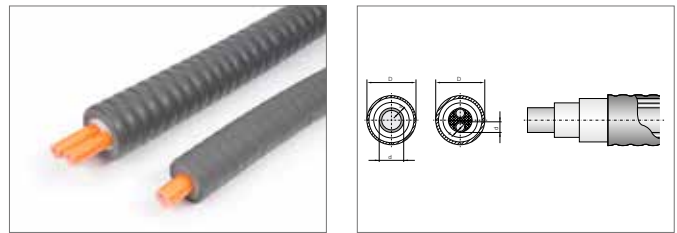

Article No.	Description	d	s	D	U-value	Volume	Max. coil length	Weight	Pack Qty
		mm	mm	mm	W/m <sup>2</sup> K	l/m	m	kg/m	m
<b>UNO</b>									
132053-001	25/120	25	2.3	113	0.16	0.327	330	1.11	330
132063-001	32/120	32	2.9	114	0.19	0.539	330	1.203	330
132073-001	40/120	40	3.7	116	0.22	0.835	330	1.318	330
132083-001	50/150	50	4.6	144	0.23	1.307	260	1.902	260
132093-001	63/150	63	5.8	145	0.28	2.075	260	2.2	260
132103-001	75/175	75	6.8	170	0.28	2.961	160	3.161	160
132113-001	90/175	90	8.2	175	0.34	4.254	160	3.754	160
132123-001	110/190	110	10	187	0.41	6.362	100	5.043	100
132133-001	125/210	125	11.4	209	0.42	8.203	100	6.381	100
319603-001	140/220	140	12.7	217	0.5	10.32	12m lengths	6.90	12
319604-001	160/250	160	14.6	237	0.55	13.44	12m lengths	9.3	12
<b>DUO</b>									
132003-001	25 + 25/150	25	2.3	144	0.25	0.327	260	1.627	260
132013-001	32 + 32/150	32	2.9	146	0.26	0.539	260	1.842	260
132023-001	40 + 40/150	40	3.7	148	0.32	0.835	260	2.109	260
132033-001	50 + 50/175	50	4.6	177	0.34	1.307	160	3.132	160
132043-001	63 + 63/210	63	5.8	208	0.38	2.075	110	4.396	110

## 2.2 RAUVITHERM Shroud Kits

### T-Shroud Set

- Properties:
- To fit the respective RAUVITHERM pipe outer jacket diameter to the T-shroud, please use the stepped end sections.
  - For the insulation, use RAUVITHERM foam sets
- Comprising:
- PE- shroud
  - Heat-shrink sleeves
  - Ventilation plugs
  - Screws
  - Sealing tape
  - Assembly instructions

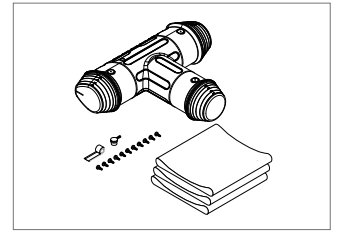

Article No.	Description	Outer Jacket $d_{min}$ mm	Outer Jacket $d_{max}$ mm	L mm	H mm	Weight kg/pc	Pack Qty pc
330024-001	<b>NEW</b> T-Shroud set small	90	162	650	530	2.738	1
330025-001	<b>NEW</b> T-Shroud set large	90	225	790	644	5.6	1

### I-Shroud Set

- Properties:
- To fit the respective RAUVITHERM pipe outer jacket diameter to the I-shroud, please use the stepped end sections
  - For the insulation, use RAUVITHERM foam sets
- Comprising:
- PE- shroud
  - Heat-shrink sleeves
  - Ventilation plugs
  - Assembly instructions

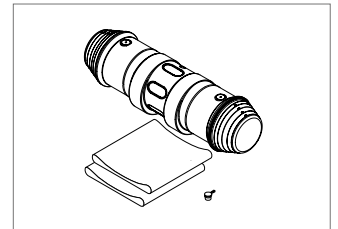

Article No.	Description	Outer Jacket $d_{min}$ mm	Outer Jacket $d_{max}$ mm	L mm	Weight kg/pc	Pack Qty pc
330068-001	<b>NEW</b> I-Shroud set small	90	62	650	1.65	1
330069-001	<b>NEW</b> I-Shroud set large	120	225	670	4.11	1

### L-Shroud Set

- Properties:
- To fit the respective RAUVITHERM pipe outer jacket diameter to the L-shroud, please use the stepped end sections
  - For the insulation, use RAUVITHERM foam sets
- Comprising:
- PE- shroud
  - Heat-shrink sleeves
  - Ventilation plugs
  - Screws
  - Assembly instructions

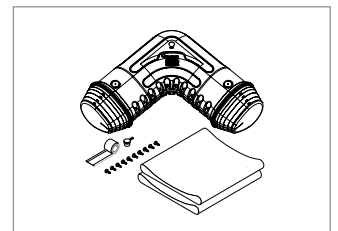

Article No.	Description	Outer Jacket $d_{min}$ mm	Outer Jacket $d_{max}$ mm	L mm	Weight kg/pc	Pack Qty pc
330026-001	<b>NEW</b> L-Shroud set small	90	162	502	2.5	1
330027-001	<b>NEW</b> L-Shroud set large	90	225	590	6	1

## REHAU Shrink Sleeve

Application: For repair of RAUVITHERM or RAUTHERMEX pipe as well as RAUVITHERM T-, I- and L-Shrouds

Article No.	Description	Weight	Pack Qty
		kg/pc	pc
353353-001	300 mm width, 970 mm length	0.7	1

## REHAU Repair Kits

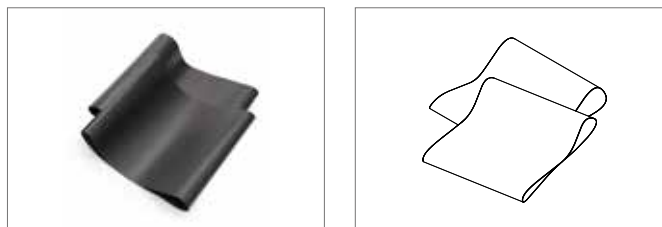

Article No.	Description	L	Weight	Pack Qty
		mm	g/m	m
297991-033	330mm(w) heat-shrink sleeve (S)	330	792	0.33
297992-040	440mm(w) heat-shrink sleeve (L) (also used for district heating chamber)	400	965	0.4

## REHAU Shroud Foam

Application: For the installation of the RAUTHERMEX shrouds and REHAU heat-shrink shrouds

Comprising:

- Foam bottle component A
- Foam bottle component B
- Nozzle cap
- Assembly instructions

Hinweis: Please observe the assembly instructions and safety datasheets



Article No.	Description	Suitable for RAUTHERMEX Shroud	Suitable for Shrink Sleeve	Weight	Pack Qty
				kg/pc	St
201273-001	Size 7		Shrink sleeve T small	1.398	1
351063-001	Size 9.1	RTX T-shroud large	Shrink sleeve T large	2.212	1
298357-001	Size 5	RTX I- and L-shroud small	Shrink sleeve I small	0.875	1
352413-001	Size 8	RTX I- and L-shroud large	Shrink sleeve I large	1.712	1
209596-001	Size 6	RTX T-shroud small	Shrink sleeve L small	1.055	1
304766-001	Size 8.1		Shrink sleeve L large	1.862	1

## 2.3 RAUVITHERM House Entries

### REHAU Pre-fabricated Pipe Bend

- Properties:
- Suitable up to max. 95 °C (short bursts) and 6 bar
  - Elbow in outer jacket made up of segments butt-welded to create a bend.
  - Pipe bend length: 1100 mm x 1600 mm
  - Leg length at: 160/250, 1500mm x 1500mm
  - Exposed pipe ends: 250 mm
- Comprising:
- Pre-bent carrier pipe made of cross-linked polyethylene (PE-Xa) in accordance to DIN 16892/93, DIN EN 15632 and oxygen diffusion barrier (EVOH) according to DIN 4726
  - Insulation made from CFC-free, pentane driven polyurethane rigid foam
  - Outer jacket pipe: PE-HD black

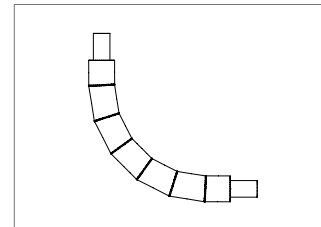
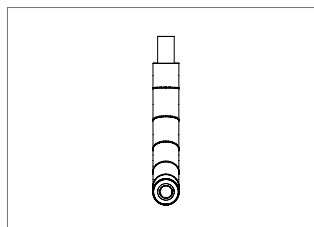
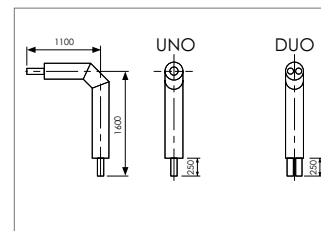

Article No.	Description	d	s	D	Weight	Pack Qty
		mm	mm	mm	kg/pc	pc
<b>UNO</b>						
240004-001	25/91	25	2.3	90	2.85	1
240064-001	32/91	32	2.9	90	3.07	1
240074-001	40/91	40	3.7	110	3.47	1
240084-001	50/111	50	4.6	110	4.92	1
240094-001	63/126	63	5.8	125	6.5	1
240054-001	75/162	75	6.8	160	8.47	1
240114-001	90/162	90	8.2	160	11.4	1
240124-001	110/162	110	10	160	14.23	1
222827-001	125/182	125	11.4	180	16.03	1
222837-001	160/250	160	14.6	250	26.55	1
<b>DUO</b>						
240194-001	25 + 25/110	2x 25	2.3	110	4.71	1
240224-001	32 + 32/110	2x 32	2.9	110	4.67	1
240234-001	40 + 40/125	2x 40	3.7	125	7.42	1
240244-001	50 + 50/160	2x 50	4.6	160	9.9	1
243788-001	63 + 63/180	2x 63	5.8	180	13.2	1

### Wall Penetrations for Pressured Water (with rough outer surface)

- Properties:
- Watertight to 2m water column
  - for direct installation with expansive mortar or concreted in
- Comprising:
- PVC wall sleeve
  - Heat-shrink sleeve

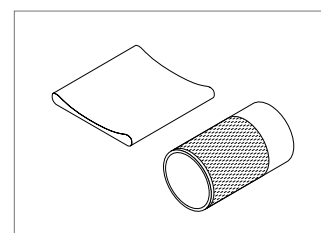

Article No.	Description	D	RVT UNO	RVT DUO	Weight	Pack Qty
		mm			kg/pc	pc
320800-001	Casing diameter 120	160	25, 32, 40		2.57	1
320801-001	Casing diameter 150,175,190	225	50, 63	25, 32, 40	4.7	1
320802-001	Casing diameter 210	280	125,140, 110	63	6.72	1

### Wall Penetrations for Pressure Water (including compact sealing ring)

- Properties: - Watertight up to 2m water column.  
 - For direct installation in a tapping drill hole
- Comprising: - PVC wall sleeve  
 - Heat-shrink sleeve  
 - Compact sealing ring

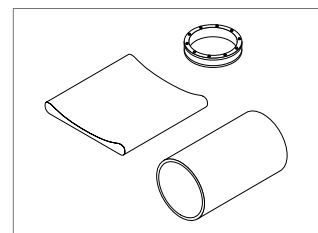

Article No.	Description	D	RVT UNO	RVT DUO	Weight	Pack Qty
		mm			kg/pc	pc
370800-001	Casing diameter 120 with KD	250	25, 32, 40		5.36	1
370801-001	Casing diameter 150,175,190 with KD	300	50, 63	25, 32, 40	7.95	1
370803-001	Casing diameter 210 with KD	350	125,140,110	63	11.32	1

### Wall Sealing Ring (Dry)

- Application: Suitable as a building inlet through masonry. in conjunction with expansive mortar for non-pressured water. Watertight up to 2m water column
- Material: Profiled natural rubber
- Colour: Black (RAL 9005)

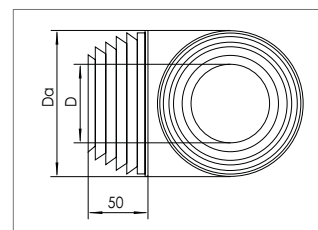

Article No.	Description	D	D <sub>a</sub>	RTX UNO	RTX DUO	RVT UNO	RVT DUO	Weight	Pack Qty
		mm	mm					kg/pc	pc
240373-001	111/153 mm	111	153	32*, 50	25,32	25, 32		0.5	1
240383-001	126/168 mm	126	168	40*, 50*,63	32*, 40	40		0.5	1
240393-001	142/183 mm	142	183	63*	40*	50, 63	25, 32, 40	0.6	1
240403-001	162/203 mm	162	203	75, 90, 110	50	75		0.7	1
239101-001	182/223 mm	182	223	90*, 110, 125	50*, 63	90, 110	50	0.8	1
353278-001	202/234 mm	202	234	125*, 140, 110**	63*,75	125	63	0.9	1

\*plus insulation

\*\*plusplus insulation

### RAUVITHERM Sealing Tape

- Application: Suitable for sealing the gap between the wall sealing ring and RAUVITHERM pipe
- Material: Butyl rubber

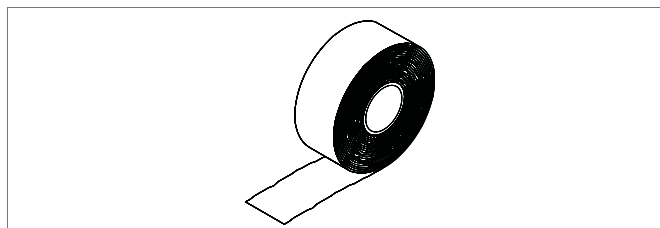

Article No.	Description	L	B	Weight	Pack Qty
		m	mm		pc
353277-001	Sealing tape for RAUVITHERM house entries	2	40	0.125	1



### RAUVITHERM Rubber End Cap

Application: Suitable for the protection of foamed pipe ends from moisture

Material: EPDM

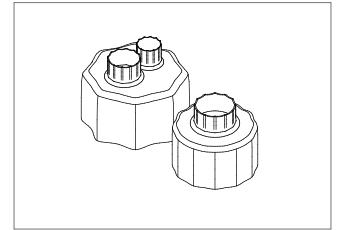
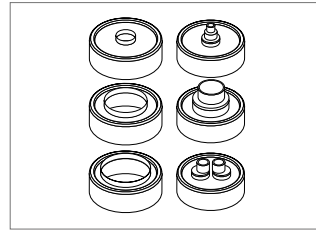

### RAUVITHERM Heat-shrink End Cap (wet)

Application: Suitable for protecting foamed pipe ends against moisture

Material: Shrinkable PE-X coated with glue

Pipe	Rubber End Cap	Heat-shrink End Cap
<b>UNO</b>		
25/120	320012-001	209961-001
32/120	320012-001	209961-001
40/120	320012-001	209961-001
50/150	320021-001	209962-001
63/150	320021-001	209962-001
75/175	218185-001	209963-001
90/175	218186-001	209963-001
110/190	320041-001	209963-001
125/210	320051-001	209963-001
<b>DUO</b>		
25+25/150	320007-001	209966-001
32+32/150	320007-001	209966-001
40+40/150	320007-001	209966-001
50+50/175	320071-001	209967-001
63+63/210	320061-001	209968-001



### 3 Special Accessories

#### District Heating Chamber

- Application: Multi-functional district heating chamber for all connections d20 - d110 or fixtures
- Properties:
- Cover and protect REHAU pipe connections, isolation valves or branches
  - Including stainless steel screw connections for the watertight and permanent connection of the cover and main body of the chamber
  - **Note:** Please check the space requirements for fittings for each individual chamber
- Material: PE
- Colour: Black

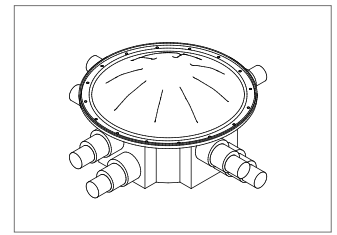

Article No.	Description	Diameter	L	B	H	Weight	Pack Qty
		mm	mm	mm	mm	kg/pc	pc
208558-001	DH chamber d 800	800	1520	1520	415	50	1

#### REHAU Pre-insulated Y-pipe, SDR 11

- Properties:
- Suitable up to max. 95 °C (short bursts) and 6 bar
  - Total Length: 1.8 m
  - Exposed pipe ends: 250 mm
- Comprising:
- Carrier pipes made of cross-linked polyethylene (PE-Xa) according to DIN 16892/93. DIN EN 15632 and oxygen diffusion barrier (EVOH) to DIN 4726
  - Insulation made with CFC-free, pentane driven polyurethane foam
  - Outer jacket: PE-HD black
  - Elbow in outer jacket made of butt-welded segments

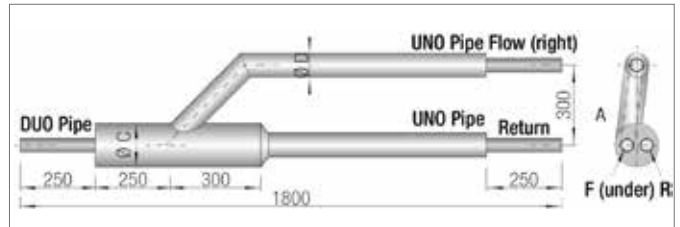

Article No.	Description	d	s	D	C	Weight	Pack Qty
		mm	mm	mm	mm	kg/pc	pc
240314-001	2 x UNO 25/91 to DUO 25 + 25/111	25	2.3	91	111	2	1
240354-001	2 x UNO 32/91 to DUO 32 + 32/111	32	2.9	91	111	5.4	1
240364-001	2 x UNO 40/91 to DUO 40 + 40/126	40	3.7	91	126	5.8	1
240374-001	2 x UNO 50/111 to DUO 50 + 50/162	50	4.6	111	162	7	1
239423-001	2 x UNO 63/126 to DUO 63 + 63/182	63	5.8	126	182	11	1
314944-001	2 x UNO 75/142 to DUO 75 + 75/225	75	6.8	142	225	14	1

#### REHAU District Heating Pipes Warning Tape

- Application: For marking the location of RAUTHERMEX and RAUVITHERM pipes. It should be installed approx. 40 cm above the pipes. The tape reads *Caution Caution Caution District Heating pipes below*
- Colour: Yellow



Article No.	Description	L	B	Weight	Pack Qty
		m	mm	g/m	m
311150-001	365m Warning tape	365	150	.	

#### 4 REHAU EVERLOC™ Jointing Technology. SDR 11

##### Compression Sleeve. SDR 11

Application: For sliding on REHAU EVERLOC™ compression sleeve fitting SDR 11 in conjunction with RAUPEX, RAUTHERM, RAUTHERMEX, RAUVITHERM and RAUGEO Pipe SDR 11

Material: Brass (LX) or Gunmetal (RG)

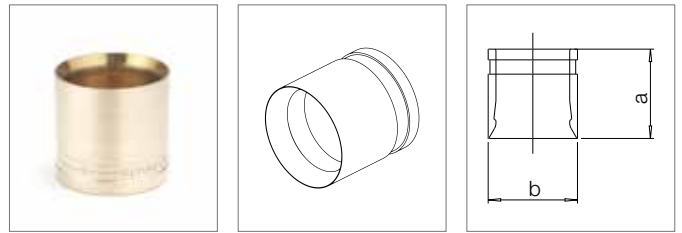

Article No.	Description	Type	a	b	Weight	Pack Qty
			mm	mm		
139562-001	20 x 1.9/2.0	LX	25	20	21.8 g/pc	100
139572-001	25 x 2.3	LX	27	30	40 g/pc	50
139492-001	32 x 2.9	LX	35	40	80 g/pc	50
138683-001	40 x 3.7	LX	37	49	131 g/pc	25
138693-001	50 x 4.6	LX	44	61	260 g/pc	25
138703-001	63 x 5.8	LX	53	74	390 g/pc	25
267671-002	75 x 6.8	RG	53	90	500 g/pc	1
267681-002	90 x 8.2	RG	53	108	520 g/pc	1
267691-002	110 x 10.0	RG	53	130	1.09 kg/pc	1
235229-002	125 x 11.4	RG	53	145	1.597 kg/pc	1
206256-002	140 x 12.7	RG	53	163	1.8 kg/pc	1
234324-002	160 x 14.6	RG	53	185	2.45 kg/pc	1

##### Straight Coupler SDR 11

Application: REHAU EVERLOC™ compression fitting with moulded support ridges for use with RAUPEX, RAUTHERM, RAUTHERMEX, RAUVITHERM and RAUGEO Pipe SDR 11 and compression sleeves SDR 11

Material: Brass (LX) or Gunmetal (RG)

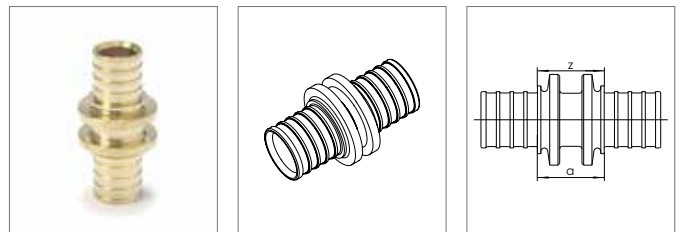

Article No.	Description	Type	a	z	Weight	Pack Qty	
			mm	mm			mm
<b>Equal</b>							
169008-001	20 x 1.9	LX	52	22	20	62 g/pc	10
169010-001	25 x 2.3	LX	67	24	25	93 g/pc	10
169013-001	32 x 2.9	LX	78	24	32	177 g/pc	3
169015-001	40 x 3.7	LX	90	28	40	380 g/pc	5
169144-001	50 x 4.6	LX	104	28	50	570 g/pc	1
169142-001	63 x 5.8	LX	122	35	63	940 g/pc	1
267611-001	75 x 6.8	RG	132	32	75	1.48 kg/pc	1
267621-001	90 x 8.2	RG	132	32	90	2.4 kg/pc	1
267631-001	110 x 10	RG	132	32	110	3.12 kg/pc	1
235219-001	125 x 11.4	RG	133	33	125	4.5 kg/pc	1
206257-001	140 x 12.7	RG	138	38	140	5 kg/pc	1
234334-001	160 x 14.6	RG	143	43	160	5.5 kg/pc	1

## Reducing Coupler SDR 11

Application: REHAU compression fitting with moulded support ridges for use with RAUPEX, RAUTHERM, RAUTHERMEX, RAUVITHERM and RAUGEO Pipe SDR 11 and compression sleeve SDR 11

Material: Brass (LX) or Gunmetal (RG)

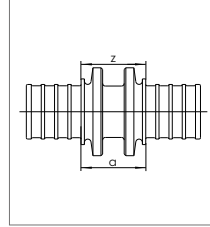
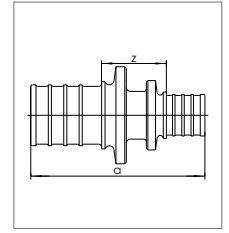
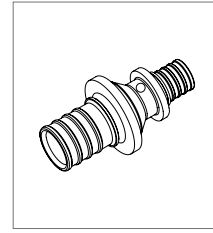

Article No.	Description	Type	a	z	Weight	Pack Qty
			mm	mm		pc
<b>Reducing</b>						
169012-001	25 - 20	LX	59	22	70 g/pc	10
169014-001	32 - 25	LX	72	23	140 g/pc	3
169016-001	40 - 20	LX	75	28	260 g/pc	5
169017-001	40 - 32	LX	87	28	280 g/pc	5
169170-001	50 - 32	LX	93	18	410 g/pc	1
169147-001	50 - 40	LX	99	28	480 g/pc	1
169148-001	63 - 50	LX	117	32	760 g/pc	1
267641-001	75 - 63	RG	132	32	1.4 kg/pc	1
267651-001	90 - 75	RG	137	36	1.7 kg/pc	1
267661-001	110 - 90	RG	137	36	3.1 kg/pc	1

## T-Piece SDR 11

Application: REHAU EVERLOC™ compression fitting with moulded support ridges for use with RAUPEX, RAUTHERM, RAUTHERMEX, RAUVITHERM and RAUGEO Pipe SDR 11 and compression sleeve SDR 11

Material: Brass (LX) or Gunmetal (RG)

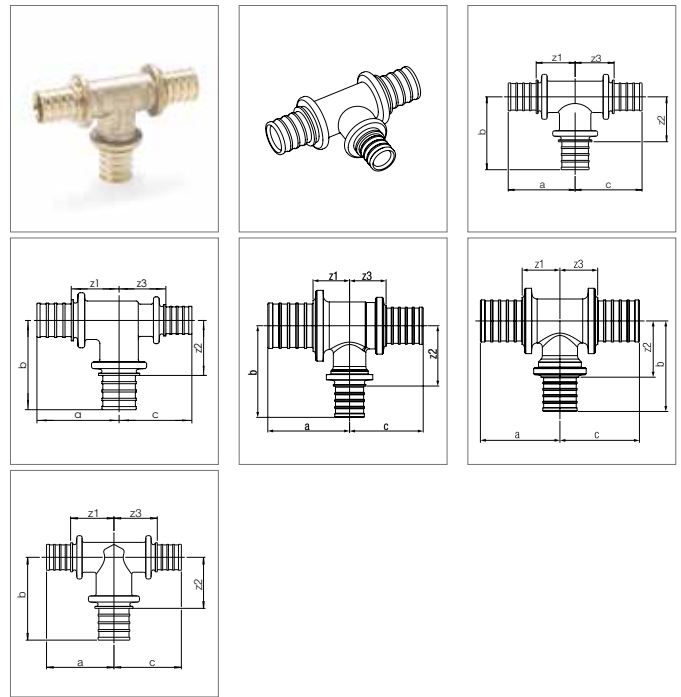

Article No.	Description	Type	a	b	c	z <sub>1</sub>	z <sub>2</sub>	z <sub>3</sub>	Weight	Pack Qty
			mm	mm	mm	mm	mm	mm		pc
<b>Equal tee</b>										
169045-001	20 - 20 - 20	LX	40	43	40	25	28	25	135 g/pc	10
169056-001	25 - 25 - 25	LX	50	54	50	29	32	29	200 g/pc	10
169063-001	32 - 32 - 32	LX	57	62	57	30	35	30	400 g/pc	3
169072-001	40 - 40 - 40	LX	67	77	67	43	53	43	770 g/pc	1
169156-001	50 - 50 - 50	LX	88	87	88	49	48	49	870 g/pc	1
169167-001	63 - 63 - 63	LX	105	108	105	59	62	59	2.35 kg/pc	1
221946-001	75 - 75 - 75	RG	117	117	117	67	67	67	2.7 kg/pc	1
221948-001	90 - 90 - 90	RG	126	126	126	76	76	76	4 kg/pc	1
221953-001	110 - 110 - 110	RG	137	137	137	87	87	87	6 kg/pc	1
<b>Tee on end and branch reduced</b>										
169049-001	25 - 20 - 20	LX	47	46	41	26	31	26	165 g/pc	10
169060-001	32 - 25 - 25	LX	55	56	48	28	33	25	259 g/pc	3
169070-001	40 - 32 - 32	LX	69	67	63	37	40	36	580 g/pc	1
169151-001	50 - 25 - 40	LX	82	69	74	43	47	42	820 g/pc	1
169153-001	50 - 32 - 40	LX	72	75	73	33	48	41	720 g/pc	1
169160-001	63 - 32 - 50	LX	98	82	88	52	53	49	1.2 kg/pc	1
169162-001	63 - 40 - 40	LX	98	87	81	52	55	49	1.5 kg/pc	1
169163-001	63 - 40 - 50	LX	97	87	89	51	55	50	1.6 kg/pc	1
169165-001	63 - 50 - 50	LX	97	94	89	51	55	50	1.6 kg/pc	1
221935-001	75 - 32 - 63	RG	92	89	88	42	59	38	2.1 kg/pc	1
221938-001	75 - 50 - 63	RG	102	102	98	52	61	48	2.4 kg/pc	1
221943-001	75 - 63 - 63	RG	109	113	105	59	62	55	2.5 kg/pc	1
<b>Tee branch reduced</b>										
169053-001	25 - 20 - 25	LX	48	47	48	26	32	26	184 g/pc	10
169059-001	32 - 20 - 32	LX	54	51	54	27	36	27	290 g/pc	3
169061-001	32 - 25 - 32	LX	57	58	57	30	36	30	310 g/pc	3
169068-001	40 - 20 - 40	LX	62	57	62	30	42	30	580 g/pc	1
169069-001	40 - 25 - 40	LX	67	66	67	43	44	43	670 g/pc	1
169071-001	40 - 32 - 40	LX	64	69	64	32	42	32	700 g/pc	1
169077-001	50 - 20 - 50	LX	69	62	69	30	47	30	810 g/pc	1
169152-001	50 - 25 - 50	LX	73	69	73	34	47	34	830 g/pc	1
169154-001	50 - 32 - 50	LX	72	75	80	33	48	41	820 g/pc	1
169155-001	50 - 40 - 50	LX	74	80	74	35	48	35	900 g/pc	1

Article No.	Description	Type	a	b	c	z <sub>1</sub>	z <sub>2</sub>	z <sub>3</sub>	Weight	Pack Qty
			mm	mm	mm	mm	mm	mm		pc
244432-001	63 - 20 - 63	LX	80	67	80	30	44	30	1.323 kg/pc	1
169159-001	63 - 25 - 63	LX	83	79	83	37	57	37	1.2 kg/pc	1
169161-001	63 - 32 - 63	LX	81	84	81	35	57	35	1.2 kg/pc	1
169164-001	63 - 40 - 63	LX	85	86	85	39	54	39	1.7 kg/pc	1
169166-001	63 - 50 - 63	LX	98	97	98	52	58	52	1.882 kg/pc	1
221934-001	75 - 25 - 75	RG	87	83	87	37	57	37	2.1 kg/pc	1
267791-001	75 - 32 - 75	RG	92	89	92	42	58	42	2.1 kg/pc	1
221936-001	75 - 40 - 75	RG	96	104	96	46	70	46	2.25 kg/pc	1
231326-001	75 - 50 - 75	RG	102	101	102	52	60	52	2.5 kg/pc	1
221944-001	75 - 63 - 75	RG	109	113	109	59	63	59	2.5 kg/pc	1
231336-001	90 - 32 - 90	RG	92	98	92	42	67	42	3 kg/pc	1
221945-001	90 - 40 - 90	RG	96	104	96	46	70	46	3.2 kg/pc	1
231346-001	90 - 63 - 90	RG	109	121	109	59	71	59	3.8 kg/pc	1
231356-001	110 - 32 - 110	RG	92	109	92	42	78	42	4.3 kg/pc	1
221950-001	110 - 50 - 110	RG	102	122	102	52	81	52	5.3 kg/pc	1
231366-001	110 - 63 - 110	RG	109	132	109	59	82	59	5.4 kg/pc	1
<b>Tee both ends reduced</b>										
169047-001	20 - 25 - 20	LX	43	50	43	28	28	28	160 g/pc	10
267781-001	63 - 75 - 63	LX	113	109	113	63	59	63	1.69 kg/pc	1
<b>Tee one end reduced</b>										
169055-001	25 - 25 - 20	LX	50	54	43	29	32	28	196 g/pc	10
169062-001	32 - 32 - 25	LX	59	64	53	32	37	32	350 g/pc	3

### REHAU T-Piece, SDR 11 including compression sleeves

Application: Steel T-piece with welded-on compression sleeve adapter for use with Carrier pipes RAUTHERMEX and RAUVITHERM SDR 11

Material: - T-piece: Steel  
- Compression sleeve: Brass/Gunmetal

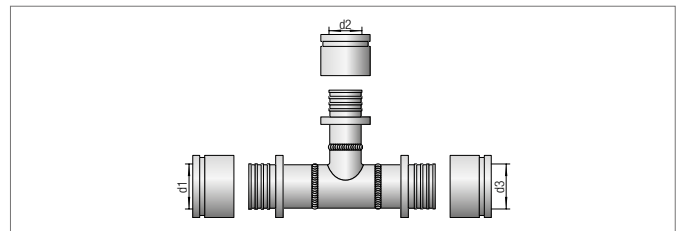

Article No.	Description	d <sub>1</sub>	d <sub>2</sub>	d <sub>3</sub>	Weight	Pack Qty
		mm	mm	mm	kg/pc	pc
222684-001	40 - 25 - 32	40	25	32	1.5	1
222704-001	50 - 40 - 40	50	40	40	2	1
222714-001	63 - 25 - 50	63	25	50	2.5	1
241194-001	75 - 25 - 63	75	25	63	2.53	1
241214-001	75 - 40 - 63	75	40	63	2.82	1
241304-001	90 - 25 - 75	90	25	75	3.84	1
241314-001	90 - 32 - 75	90	32	75	4.05	1
241324-001	90 - 40 - 75	90	40	75	4.23	1
241334-001	90 - 50 - 75	90	50	75	4.57	1
241344-001	90 - 63 - 75	90	63	75	5.09	1
241354-001	90 - 75 - 75	90	75	75	4.47	1
241434-001	110 - 25 - 90	110	25	90	5	1
241444-001	110 - 32 - 90	110	32	90	5.25	1
241454-001	110 - 40 - 90	110	40	90	5.43	1
241464-001	110 - 50 - 90	110	50	90	5.77	1
241474-001	110 - 63 - 90	110	63	90	5.77	1
241484-001	110 - 75 - 90	110	75	90	6.29	1
241494-001	110 - 90 - 90	110	90	90	7	1
352898-001	125 - 125 - 125	125	125	125	14	1
352899-001	125 - 110 - 125	125	110	125	12.5	1
352897-001	125 - 90 - 125	125	90	125	11.5	1
352896-001	125 - 75 - 125	125	75	125	11.1	1
301895-001	125 - 63 - 125	125	63	125	11	1

Article No.	Description	d <sub>1</sub>	d <sub>2</sub>	d <sub>3</sub>	Weight	Pack Qty
		mm	mm	mm	kg/pc	pc
301896-001	125 - 50 - 125	125	50	125	10	1
304004-001	125 - 40 - 125	125	40	125	10.5	1
301905-001	125 - 32 - 125	125	32	125	10.1	1
301906-001	125 - 25 - 125	125	25	125	10	1
241364-001	90 - 25 - 90	90	25	90	4.55	1
241394-001	90 - 50 - 90	90	50	90	5.28	1
241414-001	90 - 75 - 90	90	75	90	6.51	1
241504-001	110 - 25 - 110	110	25	110	5.53	1
241524-001	110 - 40 - 110	110	40	110	6.26	1
241554-001	110 - 75 - 110	110	75	110	6.78	1
241564-001	110 - 90 - 110	110	90	110	7.49	1
301897-001	125 - 125 - 110	125	125	110	13	1
301888-001	125 - 110 - 110	125	110	110	11.5	1
301889-001	125 - 90 - 110	125	90	110	10.5	1
310306-001	125 - 75 - 110	125	75	110	10	1
310307-001	125 - 63 - 110	125	63	110	10	1
310308-001	125 - 50 - 110	125	50	110	9.5	1
310316-001	125 - 40 - 110	125	40	110	9.5	1
310317-001	125 - 32 - 110	125	32	110	9	1

### T-Piece, SDR 11 Steel, pre-insulated

- Properties:
- Pre-insulated Steel T-piece including couplers with compression sleeves
  - Straight branch (125)
  - Angled branch 45° (160)
  - Size 125 - requires RAUVITHERM I-Shroud large
- Material:
- T-piece: Steel
  - Compression sleeve: Gunmetal (Rg)
  - Insulation: CFC-free polyurethane foam
  - Outer jacket: Polyethylene (PE-HD)

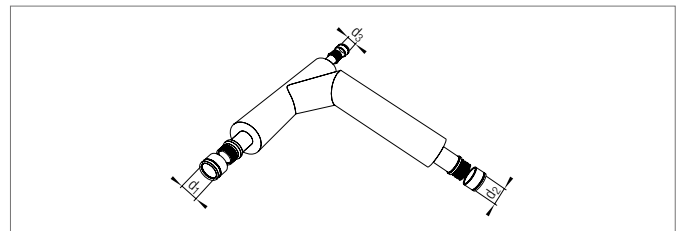

Article No.	Description	d <sub>1</sub>	d <sub>2</sub>	d <sub>3</sub>	Weight	Pack Qty
		mm	mm	mm	kg/pc	pc
201411-001	125 - 125 - 125	125	125	125	27	1
201413-001	160 - 160 - 160	160	160	160	50	1



### T-Piece Branch with Female Thread. SDR 11

Application: REHAU EVERLOC™ compression fitting with moulded support ridges for use with RAUPEX, RAUTHERM, RAUTHERMEX, RAUVITHERM and RAUGEO pipe SDR 11 and compression sleeve SDR 11

Material: Brass  
Colour: Brass

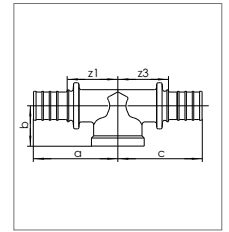
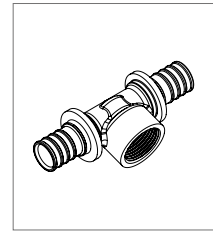

Article No.	Description	a	b	c	z <sub>1</sub>	z <sub>3</sub>	Weight	Pack Qty
		mm	mm	mm	mm	mm		pc
<b>Equal</b>								
169048-001	20 - Rp 1/2 - 20	45	25	45	30	30	151 g/pc	10
169057-001	25 - Rp 1/2 - 25	56	26	56	35	35	215 g/pc	10
169058-001	25 - Rp 3/4 - 25	56	28	56	35	35	225 g/pc	10
169064-001	32 - Rp 1/2 - 32	56	28	56	29	29	275 g/pc	3
169065-001	32 - Rp 1 - 32	67	30	67	40	40	420 g/pc	3
169067-001	32 - Rp 3/4 - 32	67	36	67	40	40	345 g/pc	1
169073-001	40 - Rp 1/2 - 40	63	40	63	31	31	560 g/pc	1
169075-001	40 - Rp 1 - 40	72	37	75	40	42	700 g/pc	1
169076-001	40 - Rp 3/4 - 40	67	41	67	35	35	613 g/pc	1
169158-001	50 - Rp 1 - 5	85	43	87	46	48	930 g/pc	1
169078-001	50 - Rp 1 1/4 - 50	85	45	87	46	48	970 g/pc	1
169079-001	50 - Rp 1/2 - 50	70	45	70	22	22	807 g/pc	1
169080-001	50 - Rp 3/4 - 50	74	46	74	35	35	1.02 kg/pc	1
169082-001	63 - Rp 1/2 - 63	82	55	82	36	36	1.1 kg/pc	1
169083-001	63 - Rp 3/4 - 63	45	25	45	30	30	1.27 kg/pc	1
<b>Reduced End</b>								
169074-001	40 - Rp 1 - 32	72	37	79	40	43	610 g/pc	1
169157-001	50 - Rp 1 1/4 - 40	85	43	80	46	46	890 g/pc	1

## Elbow SDR 11

Application: REHAU EVERLOC™ fitting with moulded support ridges for use with RAUPEX, RAUTHERM, RAUTHERMEX, RAUVITHERM and RAUGEO pipe SDR 11 and compression sleeve SDR 11

Material: Brass or Gunmetal

Colour: Brass (LX) or Gunmetal (RG)

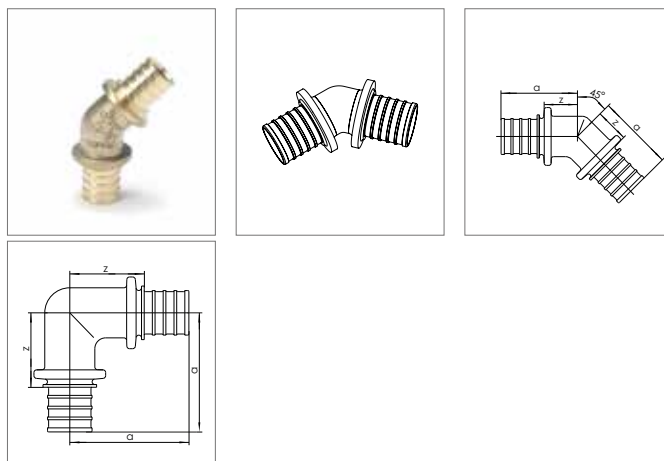

Article No.	Description	Type	a	z	Weight	Pack Qty
			mm	mm		pc
<b>45</b>						
169125-001	25 - 25, 45 Degrees	LX	46	20	0.137 kg/pc	10
169127-001	32 - 32, 45 Degrees	LX	54	27	0.259 kg/pc	3
169129-001	40 - 40, 45 Degrees	LX	58	27	0.457 kg/pc	1
169131-001	50 - 50, 45 Degrees	LX	67	28	0.7 kg/pc	1
169150-001	63 - 63, 45 Degrees	LX	81	35	1.305 kg/pc	1
237836-001	75 x 6.8, 45 Degrees	RG	85	35	1.72 kg/pc	1
<b>90</b>						
169124-001	20 - 20, 90 Degrees	LX	44	29	0.107 kg/pc	10
169126-001	25 - 25, 90 Degrees	LX	54	32	0.16 kg/pc	10
169128-001	32 - 32, 90 Degrees	LX	64	37	0.29 kg/pc	3
169130-001	40 - 40, 90 Degrees	LX	74	42	0.52 kg/pc	1
169145-001	50 - 50, 90 Degrees	LX	87	48	820 g/pc	1
169146-001	63 - 63, 90 Degrees	LX	106	60	1.5 kg/pc	1
267751-001	75 x 6.8, 90 Degrees	RG	117	67	2.44 kg/pc	1
267761-001	90 x 8.2, 90 Degrees	RG	127	76	3.15 kg/pc	1
267771-001	110 x 10.0, 90 Degrees	RG	137	87	5.01 kg/pc	1

## Male Adapter with Male Thread, SDR 11

Application: REHAU EVERLOC™ fitting with moulded support ridges for use with RAUPEX, RAUTHERM, RAUTHERMEX, RAUVITHERM and RAUGEO pipe SDR 11 and compression sleeve SDR 11

Material: Brass or Gunmetal

Colour: Brass (LX) or Gunmetal (RG)

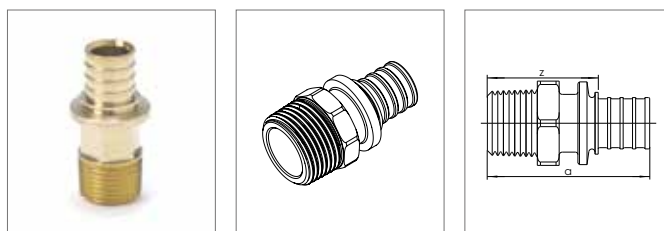

Article No.	Description	Type	a	z	SW	Weight	Pack Qty
			mm	mm			pc
169097-001	20 - R 1/2 - L15	LX	54	39	26	0.082 kg/pc	10
169098-001	20 - R 3/4 - L18	LX	53	38	28	0.095 kg/pc	10
169104-001	25 - R 1 - L22	LX	63	42	31	0.169 kg/pc	10
169105-001	25 - R 3/4	LX	59	38	34	0.11 kg/pc	10
169109-001	32 - R 1 - L22	LX	69	42	40	0.16 kg/pc	3
169111-001	40 - R 1 1/4	LX	82	50	36	0.35 kg/pc	5
169149-001	50 - R 1 1/4	LX	89	50	41	480 g/pc	1
169143-001	50 - R 1 1/2	LX	89	50	41	510 g/pc	1
169141-001	63 - R 2	LX	100	54	55	800 g/pc	1
267581-001	75 x 6.8 - R 2 1/2	RG	110	60	73	1.66 kg/pc	1
267591-001	90 x 8.2 - R 3"	RG	111	60	90	2.11 kg/pc	1
267601-001	110 x 10.0 - R 4"	RG	119	60	110	3.9 kg/pc	1
235239-001	125 x 11.4 - R 5"	RG	116	66	120	5.2 kg/pc	1

## End caps

Application: End caps with female thread to cap off pipe ends or valves with male threads.

- Properties:
- End cap without washer
  - To achieve a tight seal the end cap must be fitted competently onto a slightly roughened and with hemp prepared male thread of the sealing / tapered type (R)
  - the end caps make it possible to cap off pipe ends with REHAU male thread adaptors in heating networks allowing future extension of the network

Material: Brass



Article No.	Description	Weight	Pack Qty
		kg/pc	pc
380091-001	¾	0.042	1
380095-001	1 ½	0.179	1
380094-001	1 ¼	0.124	1
380093-001	1 inch	0.077	1
380096-001	2 inches	0.259	1
380097-001	2 ½	0.437	1

## Female Adapter with Female Thread SDR 11

Application: REHAU EVERLOC™ fitting with moulded support ridges for use with RAUPEX, RAUTHERM, RAUTHERMEX, RAUVITHERM and RAUGEO pipe SDR 11 and compression sleeve SDR 11

Material: Brass

Colour: Brass

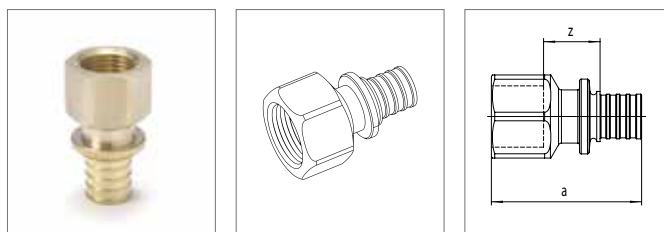

Article No.	Description	a	z	SW	Weight	Pack Qty
		mm	mm		kg/pc	pc
169099-001	20 - Rp ½	53	20	27	0.101	10
169100-001	20 - Rp ¾	50	19	34	0.146	10
169107-001	25 - Rp ¾	56	18	34	0.16	10
169106-001	25 - Rp 1	61	20	41	0.2	10
169110-001	32 - Rp 1	66	39	41	0.18	3

## Adapter with Welding End SDR 11

Application: REHAU EVERLOC™ compression fitting with moulded support ridges for use with RAUPEX and RAUTHERM pipe SDR 11 and compression sleeve SDR 11 for welding with a corresponding steel tube

Material: Steel P355N

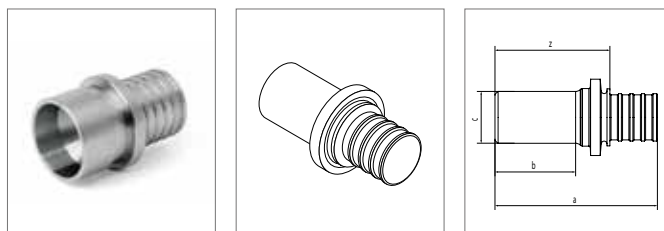

Article No.	Description	a	b	c	z	Weight	Pack Qty
		mm	mm	mm	mm		pc
267161-001	25 x 2.3 - 26 x 2.9	50	20	26.9	30	70 g/pc	10
267181-001	32 x 2.9 - 33.7 x 2.6	60	24	33.7	34	130 g/pc	3
267201-001	40 x 3.7 - 42.4 x 2.6	70	29	42.4	37	270 g/pc	3
267221-001	50 x 4.6 - 48.3 x 2.6	85	37	48.3	47	410 g/pc	1
267241-001	63 x 5.8 - 60.3 x 2.9	90	32	60.3	45	550 g/pc	1
267261-001	75 x 6.8 - 76.1 x 2.9	95	35	76.1	45	840 g/pc	1
267281-001	90 x 8.2 - 88.9 x 3.2	95	35	88.9	45	1.15 kg/pc	1
267301-001	110 x 10 - 114.3 x 3.6	90	30	114.3	40	1.55 kg/pc	1
235209-001	125 x 11.4 - 139.6 x 3.6	108	48	139.7	59	3.5 kg/pc	1
206253-001	140 x 12.7 - 139.7 x 3.6	112	50	145	62	4.5 kg/pc	1
231626-001	160 x 14.6 - 168.3 x 4.1	114	50	168.3	64	6 kg/pc	1

### REHAU Adapter with Welding End, PN16 Flange

REHAU EVERLOC™ compression fitting with moulded support ridges for use with RAUPEX and RAUTHERM pipes and REHAU EVERLOC™ compression sleeves PN16 Flange.

Only suitable for heating applications

Material: Steel 1.0038(St.37)

Article Nr.	Description	Delivery Unit
311470-010	50mm Adapter with 1 ½" PN16 flange	1 Piece
311480-010	63mm Adapter with 2" PN16 flange	1 Piece
311490-010	75mm Adapter with 2 ½" PN16 flange	1 Piece
311500-010	90mm Adapter with 3" PN16 flange	1 piece
311510-010	110mm Adapter with 4" PN16 flange	1 Piece
311520-010	125mm Adapter with 5" PN16 flange	1 Piece
305146-001	140mm Adapter with 5" PN16 flange	1 Piece
311530-010	160mm Adapter with 6" PN16 flange	1 Piece

### Elbow Adapter with Male Thread SDR11

Application: REHAU EVERLOC™ compression fitting with moulded support ridges for use with RAUPEX, RAUTHERM, RAUTHERMEX, RAUVITHERM and RAUGEO pipe SDR 11 and compression sleeve SDR 11

Material: Brass

Colour: Brass

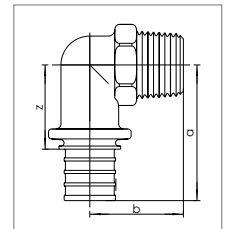
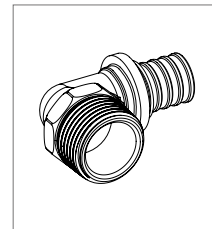

Article No.	Description	a	b	z	SW	Weight	Pack Qty
		mm	mm	mm		kg/pc	pc
169138-001	20 - R ½	44	30	27	23	0.095	10
169139-001	20 - R ¾	48	34	29	29	0.115	10
169140-001	25 - R ¾	54	37	29	29	0.18	10
169026-001	32 x 2.9 - R 1	65	36	30		0.198	3

### Ball Valve SDR 11

- Application: REHAU ball valve with hand lever, with EVERLOC™ connections on both sides in conjunction with RAUPEX, RAUTHERM, RAUTHERMEX, RAUVITHERM and RAUGEO pipe SDR 11 and compression sleeve SDR 11
- Material:
- Body: DZR special brass according to DIN EN 12164 to 12168
  - Seals: PTFE
  - Ball: Brass chrome
  - Hand lever: Galvanised steel, plastic coated

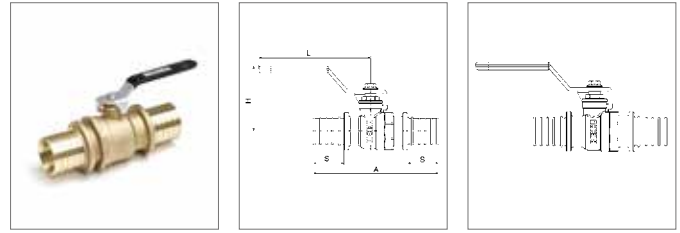

Article No.	Description	A	H	L	S	Weight	Pack Qty
		mm	mm	mm	mm		pc
233143-001	20 x 1.9 - 20 x 1.9	85	39	81	18	210 g/pc	1
160162-001	<b>NEW</b> 25 x 2.3 - 25 x 2.3	104	54	92	26	344 g/pc	1
233183-001	32 x 2.9 - 32 x 2.9	128	58	92	31	553 g/pc	1
233213-001	40 x 3.7 - 40 x 3.7	148	66	127	34	998 g/pc	1
233233-001	50 x 4.6 - 50 x 4.6	173	72	127	41	1.597 kg/pc	1
160222-001	<b>NEW</b> 63 x 5.8 - 63 x 5.8	204	82	142	50	2.815 kg/pc	1

### Ball Valve SDR 11 with Male Thread

- Application: REHAU ball valve with hand lever, with EVERLOC™ connection on one side and male thread on the other, for connecting to RAUPEX, RAUTHERM and RAUGEO pipe SDR 11 and compression sleeve SDR 11
- Material:
- Body: DZR special brass according to DIN EN 12164 to 12168
  - Seals: PTFE
  - Ball: Brass chrome
  - Hand lever: Galvanised steel, plastic coated

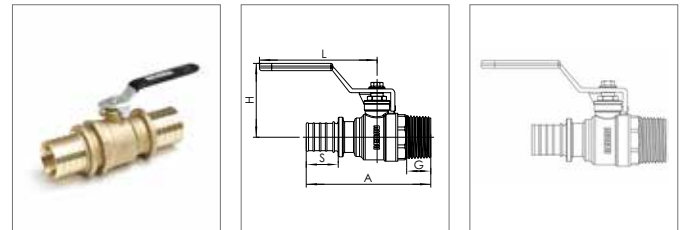

Article No.	Description	A	H	L	S	G	SW	Weight	Pack Qty
		mm	mm	mm	mm	mm		g/pc	pc
233153-001	20 x 1.9 - R ¾"	79	54	92	18	17	28	267	1
160172-001	<b>NEW</b> 25 x 2.3- R1"	98	58	92	26	20	35	344	1
160192-001	<b>NEW</b> 32 x 2.9 - R 1"	104	58	92	31	20	35	466	1

## REHAU Screw Fittings

Application: For connecting RAUTHERMEX and RAUVITHERM FW pipes in an accessible and inspected location  
 Material: Brass



Article No.	Description	Weight	Pack Qty
		kg/pc	pc
310681-001	25 x 2.3 on 3/4"	0.166	1
287083-001	32 x 2.9 on 1"	0.35	1
131277-001	40 x 3.6 on 1 1/4"	0.423	1
355534-001	50 x 4.6 on 1 1/2"	0.92	1

## REHAU Isolation Valves with Compression Sleeves

Properties: **Note:** reducing shrouds will be required  
 Comprising:
 

- Isolation valve with ball valve
- Outer jacket: PE-HD black
- 6kt connection for sprindle extending
- 6kt key
- Compression sleeves for connection to carrier pipes RAUTHERMEX and RAUVITHERM SDR 11

 Material:
 

- Shut-off valve: Steel
- Insulation: Polyurethane foam

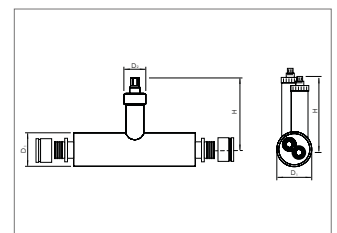

Article No.	Description	d <sub>1</sub>	d <sub>2</sub>	H	SW	Weight	Pack Qty
		mm	mm	mm		kg/pc	pc
<b>UNO</b>							
353285-001	25	110	110	475	19	6.25	1
352926-001	32	110	110	480	19	8	1
352927-001	40	125	110	485	19	9.3	1
352937-001	50	125	110	495	19	11.2	1
352928-001	63	140	110	500	19	13	1
352919-001	75	160	110	505	19	17.3	2
352924-001	90	200	110	515	19	21.5	1
352975-001	110	225	125	525	27	33	1
352923-001	125	250	125	545	27	46	1
<b>DUO</b>							
353295-001	25 + 25	140	110	475	19	14	1
353305-001	32 + 32	140	110	480	19	15	1
353315-001	40 + 40	160	110	485	19	17	1
353325-001	50 + 50	180	110	495	19	21	1
353335-001	63 + 63	225	110	500	19	24	1
357600-001	75 + 75	250	110	505	19	59.122	1

## 5. Installation Aids

### REHAU Pipe Twisting Tool

Application: For aligning/turning of DUO pipes when connecting carrier pipes together

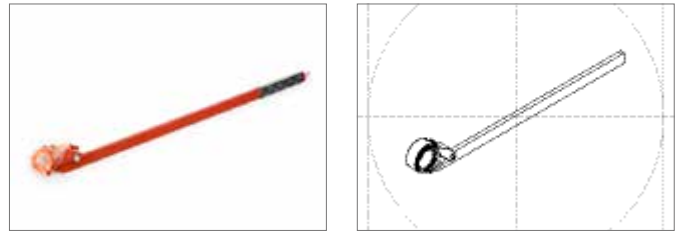

Article No.	Description	Weight kg/pc	Packing Qty pc
314945-100	Pipe Twisting Tool	8	1

### REHAU Pipe Straightening Tool STRAITA

Application: For straightening/aligning pipes for simple and easier joint making

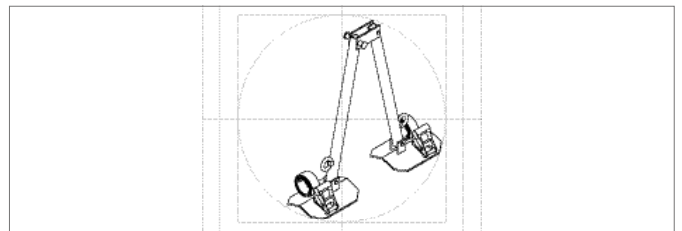

Article No.	Description	Weight kg/pc	Packing Qty pc
314083-100	Pipe straightening tool STRAITA	20	1

### REHAU Unwinder

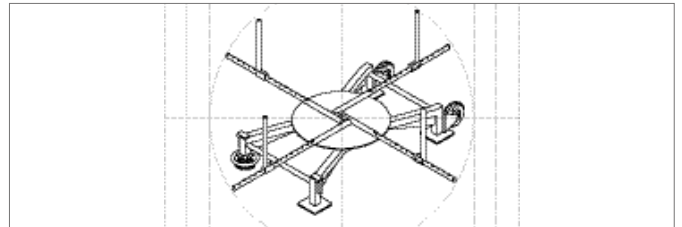

Article No.	Description	Weight kg/pc	Packing Qty pc
304529-100	Pipe unwinder	80	1

## Follow REHAU Renewables:



Our verbal and written advice with regard to usage is based on years of experience and standardised assumptions and is provided to the best of our knowledge. The intended use of REHAU products is described comprehensively in the technical product information. The latest version can be viewed at [www.rehau.com/ti](http://www.rehau.com/ti). We have no control over the application, use or processing of the products. Responsibility for these activities therefore remains entirely with the respective user/processor. Where claims for liability nonetheless arise, they shall be governed exclusively according to our terms and conditions, available at [www.rehau.com/conditions](http://www.rehau.com/conditions), insofar as nothing else has been agreed upon with REHAU in writing. This shall also apply for all warranty claims, with the warranty applying to the consistent quality of our products in accordance with our specifications. Subject to technical changes.

### UK HEAD OFFICE

Rehau Ltd, UK Head Office, Hill Court, Walford, Ross-on-Wye, Herefordshire HR9 5QN Phone: 01989 762 600 Fax: 01989 762 601

### UK & IRELAND SALES OFFICE

**London**, REHAU Ltd, The Building Centre, 25 Store Street, London WC1E 7BT Phone: 0207 580 6155 Fax: 0207 307 8595 **Slough**, Units 5 J & K, Langley Business Centre, Station Road, Langley, Slough SL3 8DS Phone: 01753 588500 Fax: 01753 588501 **Manchester**, Brinell Drive, Irlam, Manchester M44 5BL Phone: 0161 777 7400 Fax: 0161 777 7401 **Glasgow**, Phoenix House, Phoenix Crescent, Strathclyde Business Park, Bellshill, North Lanarkshire ML4 3NJ Phone: 01698 503700 Fax: 01698 503701 **Dublin**, 9 St. Johns Court, Business Park, Swords Road, Santry, Dublin 9 Phone: 00353 (0)1 8165020 Fax: 00353 (0)1 8165021

© REHAU Ltd  
Hill Court, Walford  
Ross-on-Wye  
Herefordshire, HR9 5QN  
[www.rehau.uk](http://www.rehau.uk)

Subject to Technical Alterations  
817302 EN 07.2018